

QL-12E load cells are available in the capacities from 5kg to 20kg.

Alloy aluminum construction with parallel beam type.

Silicon adhesive sealed, surface anodized and anti-corrosion.

Integral structure and easy installation.

Suitable for electronic counting scales, platform scales, electronic balance and other electronic weighing devices.



Features:

Capacity : 5kg to 20kg

Defend grade:IP65

High accuracy.

Alloy aluminum parallel beam

Max. platform size:250x350mm

Integral structure, reliable performance, and easy installation

Electrical connection and Dimensions:

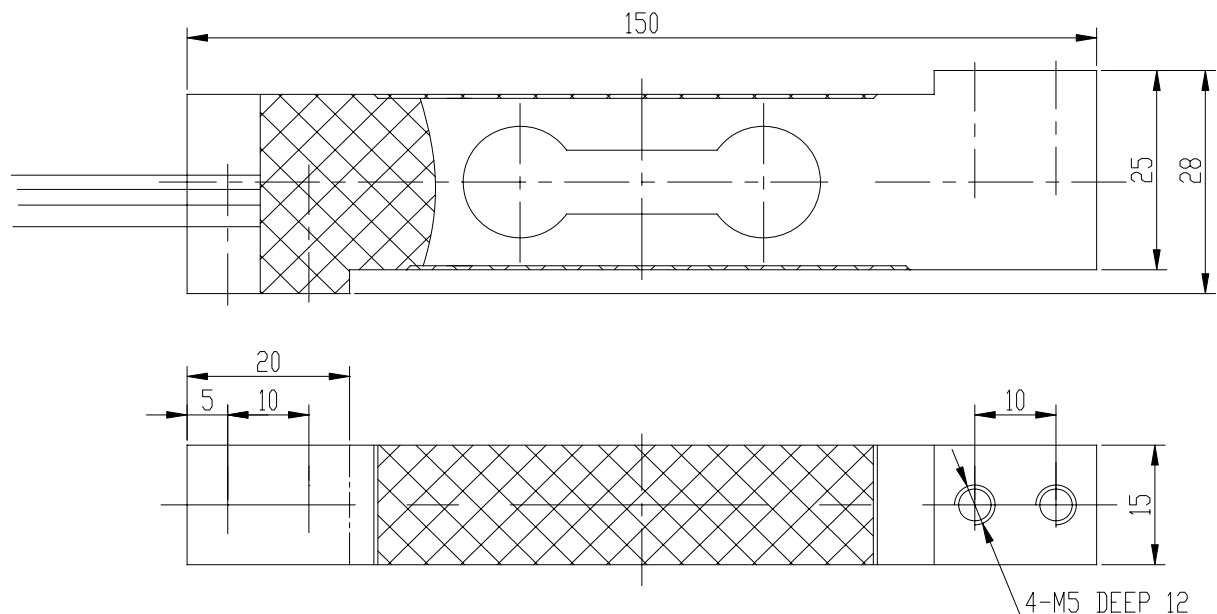

QY Electronic Co Ltd

Address: No. 1032, Xinghan Road, Hantai District, Hanzhong, Shaanxi, China (Mainland)

Website: www.qysensor.com

TEL: +86-(0)916-2257989

E-mail: info@qysensor.com

Zip: 723000

Technical Specifications

Specifications:		
capacity	kg	5,10,20
safe overload	%FS	120
ultimate overload	%FS	150
rated output	mV/V	1.1 ± 0.1
excitation voltage	Vdc	9 ~ 12
combined error	%FS	± 0.02
zero unbalance	%FS	± 1
non-linearity	%FS	± 0.02
hysteresis	%FS	± 0.02
repeatability	%FS	± 0.02
creep	%FS/30min	± 0.02
input resistance	Ω	450 ± 10
output resistance	Ω	350 ± 3
insulation resistance	M Ω	$\geq 5000 @ 100 \text{ Vdc}$
operating temperature range	$^{\circ}\text{C}$	-20 ~ +60
compensated temperature range	$^{\circ}\text{C}$	-10 ~ +40
temperature coefficient of SPAN	%FS/ 10°C	± 0.02
temperature coefficient of ZERO	%FS/ 10°C	± 0.03

Electrical connection:

Excitation+ red Excitation- black Signal+ green Signal- white

Four-core shielded cable with polyethylene. Cable is not connected with elastomer.

Four-color cable length: 0.25 m

Cable diameter : 0.8 mm

The cable length could be chose by customer's application.