

QL-12D load cells are available in the capacities from 0.3kg to 12kg.

Alloy aluminum construction with parallel beam type.

Silicon adhesive sealed, surface anodized and anti-corrosion.

Integral structure and easy installation.

Suitable for electronic counting scales, platform scales, electronic balance and other electronic weighing devices.



### Features:

Capacity : 0.3kg to 12kg

Defend grade: IP65

High accuracy.

Alloy aluminum parallel beam

Max. platform size: 200x200mm

Integral structure, reliable performance, and easy installation

### Electrical connection and Dimensions:

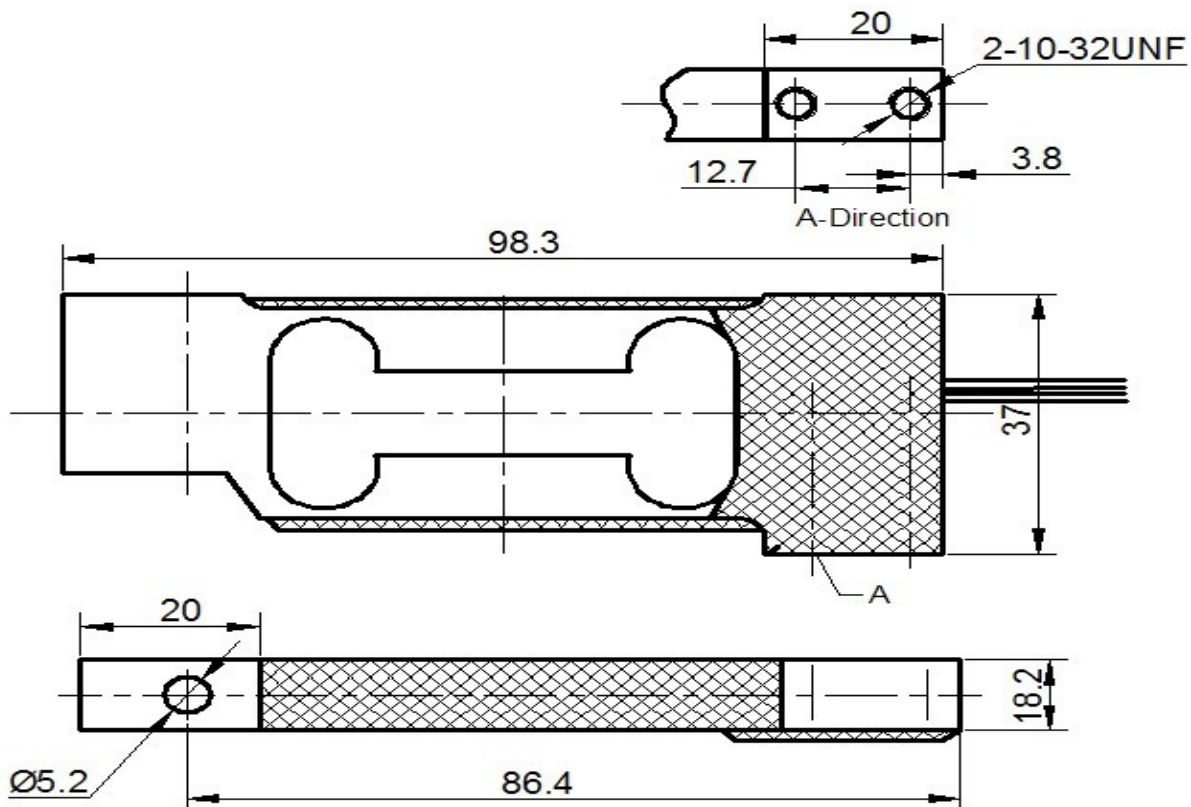

### Technical Specifications

Specifications:		
capacity	kg	0.3,0.5,1,1.5,2,3, 5,8,10,12
safe overload	%FS	120
ultimate overload	%FS	150
rated output	mV/V	$2.0 \pm 0.2$
excitation voltage	Vdc	9~ 12
combined error	%FS	$\pm 0.02$
zero unbalance	%FS	$\pm 2$
non-linearity	%FS	$\pm 0.02$
hysteresis	%FS	$\pm 0.02$
repeatability	%FS	$\pm 0.01$
creep	%FS/30min	$\pm 0.02$
input resistance	$\Omega$	$406 \pm 10$
output resistance	$\Omega$	$350 \pm 3$
insulation resistance	M $\Omega$	$\geq 5000 @ 50 \text{ Vdc}$
operating temperature range	$^{\circ}\text{C}$	-20 ~ +60
compensated temperature range	$^{\circ}\text{C}$	-10 ~ +40
temperature coefficient of SPAN	%FS/10 $^{\circ}\text{C}$	$\pm 0.02$
temperature coefficient of ZERO	%FS/10 $^{\circ}\text{C}$	$\pm 0.03$

### Electrical connection:

Excitation+ red      Excitation- black      Signal+ green      Signal- white

Four-core shielded cable with polyethylene. Cable is not connected with elastomer.

Cable length: 0.25 m

Cable diameter :  $0.8 \pm 0.2 \text{ mm}$

The cable length could be chose by customer's application.